

ROD-LATCH SYSTEM

SWINGHANDLE GEAR BOX

502

ALL IN METAL

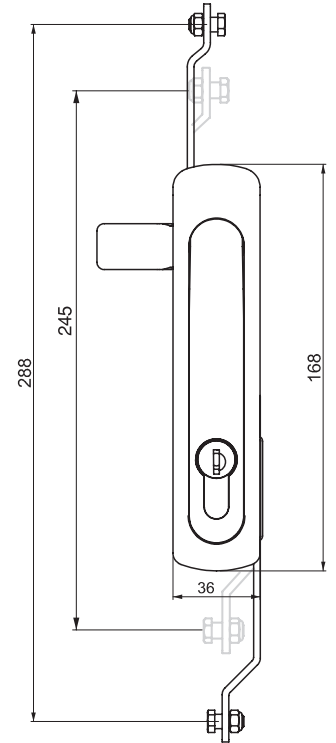
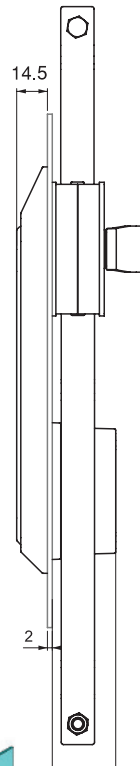
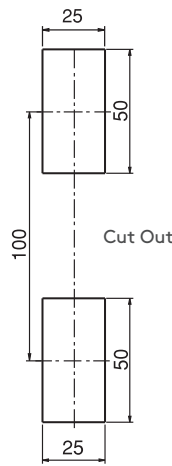
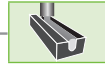

25.5: Zamak cylinder
32: Brass cylinder

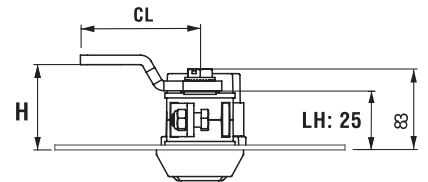

- Stainless steel version: page 454
- Die-cast construction stronger than polyamide
- Thin external profile, 14.4 mm, for flush appearance
- High-security, brass, Euro Profile single-cylinder available
- Dust cap available
- Padlockable version available
- For different colours contact Essentra

MATERIAL

BODY: Zamak DIN-EN 1774-ZnAl4Cu1
HANDLE: Zamak DIN-EN 1774-ZnAl4Cu1
MECHANISM: Zamak DIN-EN 1774-ZnAl4Cu1
SEAL: Polyurethane

PRODUCT CODE

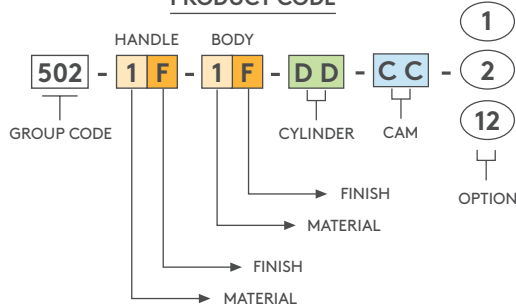

1 Dust cap application
2 Padlock application



12 Dust cap + padlock application

MATERIAL	M	FINISH	F
Zamak	1	Chrome	1
		Black coated	2

ZAMAK CYLINDER	DD
Keyed alike (Stainless steel dust cap)	03
Keyed differ (Stainless steel dust cap)	32
CH751 (Stainless steel dust cap)	07

BRASS CYLINDER	DD
No cylinder	00
Keyed alike	11

HIGH-SECURITY CYLINDER			
Brass cylinder		Zamak cylinder	
Keyed alike	Keyed differ	Keyed alike	Keyed differ
20	21	22	23

- For cams please check pages: 172 - 173
- For rods please check pages: 178 - 188
- For keys please check pages: 189 - 191