

Distributed by TROPAC

telergon
gorlan



S6 Series AC Switch-Disconnectors

S6 AC Switch - disconnecter base mounting 2P - 3P - 3P+N

Size 1

A 250|315|400|500



CODE - 2P

- 250A S6-02502PS0
- 315A S6-03152PS0
- 400A S6-04002PDO
- 500A S6-05002PDO



2P



CODE - 3P

- 250A S6-02503PS0
- 315A S6-03153PS0
- 400A S6-04003PDO
- 500A S6-05003PDO

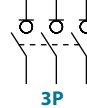

3P



CODE - 3P+N

- 250A S6-02503NS0
- 315A S6-03153NS0
- 400A S6-04003ND0
- 500A S6-05003ND0

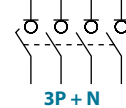

3P + N

Technical information

According to IEC 60947-3



consult

tests:



		250 315 400 500					
Rated thermal current in ambient at	lth 40° C	A	250	315	400	500	
	50° C	A	250	315	400	500	
	60° C	A	250	315	400	500	
Rated insulation voltage	Ui	V	1000	1000	1000	1000	
Rated impulse withstand voltage	Uimp	kV	12	12	12	12	
AC Rated operational current ^{*(1)}	Ie Triphasic	Ue 400V AC23A	A	250	315	400	500
		Ue 690V AC21A	A	250	315	400	500
		Ue 800V AC21B	A	-	-	250 ^{*(3)}	-
Rated breaking capacity	400V, cos φ=0,35-0,45	A	2000	2520	3200	3200	
Rated making capacity	400V, cos φ=0,45	A	2500	3150	4000	4000	

		250 315 400 500			
Short-circuit behaviour					
Rated short-circuit making capacity ^{*(2)}	Icm kA (peak)	20	20	20	20
Rated short-time withstand current (1sec)	Icw kA rms	12	12	12	12
Mechanical features					
Number of mechanical operations (according to the standards, for other values please consult)	Cycles	8000	8000	8000	8000
Maximum weight 2P	kg	1,65	1,65	1,68	1,68
Maximum weight 3P	kg	2,17	2,17	2,21	2,21
Maximum weight 3P+N	kg	2,70	2,70	2,76	2,76

^{*(1)} Other voltages and / or utilization categories. Please consult

^{*(2)} Without limiting protective device (short-circuit maintained 50... 100 ms.)

^{*(3)} 3P/3P+N

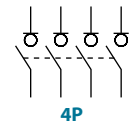

4P

Also available 4P switch-disconnectors under request, please consult

Mounting positions

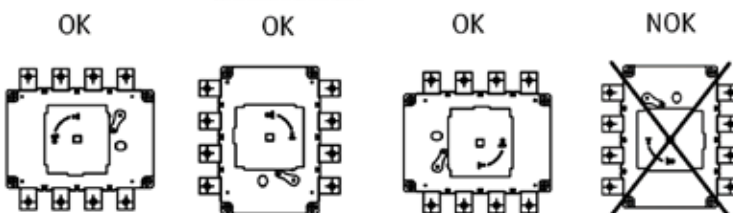

Warning: For the acceptable mounting positions, please consult the installation instructions. Do not install at 270 degrees orientation.



Accessories



» Direct handle

CODE DS-SI11



» External handle included shaft^{*(e1)}

IP65
CODE DS-SA11



» External handle without shaft

IP65
CODE DS-SA14



» Emergency external handle included shaft^{*(e1)}

IP65
CODE DS-SR11

» Shafts

Standard shaft included^{*(e1)}

L (mm)	P (mm)
227	103... 256

Shaft extensions

Type 1

L (mm)	P (mm)	CODE
375	103... 415	DS-EP14

Type 2

L (mm)	P (mm)	CODE
536	103... 576	DS-EP15

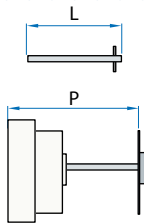

» Auxiliary contacts

1NO+1NC CODE D5LAU01
2NO+2NC CODE D5LAU02

Ie = 16 A (resistive loads)
4 A (inductive loads) at 250 Vac.



» Terminal shrouds

CODE DR-CU11 (1 unit)
CODE DR-CU12 (1 unit)
CODE DR-CU13 (1 unit)



» Phase barriers

CODE DR-SF11 (1 unit)
CODE DR-SF12 (2 units)
CODE DR-SF13 (3 units)



» Spacers

CODE DR-EL11 (4 units)



» Safety key lock device

Simple CODE DS-CA11
Double CODE DS-CE11

For external handle, lock the handle by means of a key in position "OFF" (under request, in "ON"), the key can only be removed with the handle locked

Door drilling for handle and key lock device

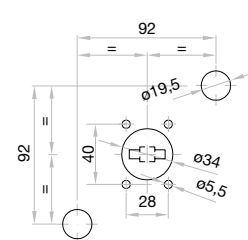
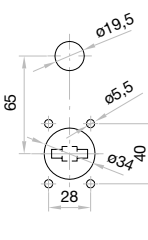

Dimensions (mm)

Door drilling for external handle

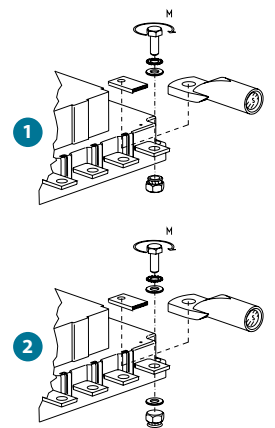
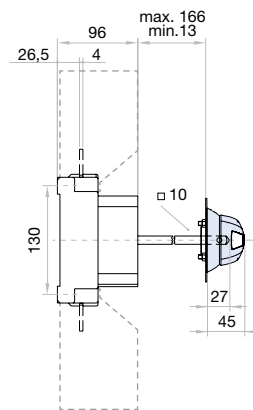
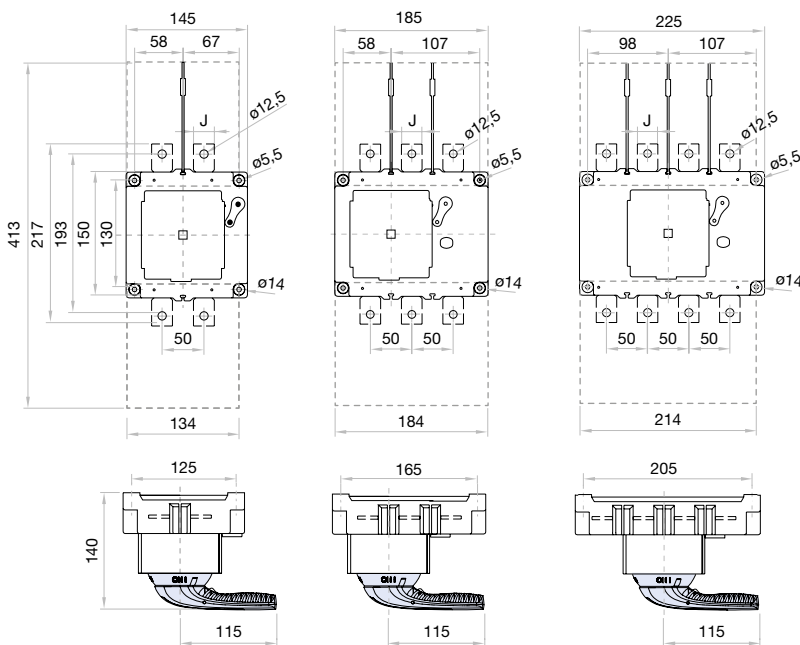
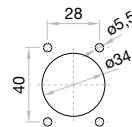

	J
	mm
250-315 A	25
400A	30
500A	30

S max (Cu)	H max (Cu)	L max (Cu)	M
mm ²	mm	mm	Nxm
250-315 A	185	8	25 M12 24
400 A	240 ^{*(e1)}	8	30 M12 24
500 A	2x150	2x7	30 M12 24

^{*(e1)} Using phase barriers DR-SF__ to maintain the required clearance.

2P

3P

3P+N

S6 AC Switch - disconnecter base mounting 2P - 3P - 3P+N

Size 2

A 630|800|



CODE - 2P

630A S6-06302PS0
800A S6-08002PD0



CODE - 3P

630A S6-06303PS0
800A S6-08003PD0

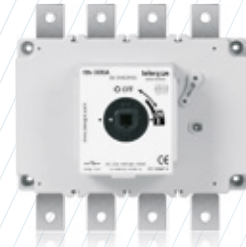

CODE - 3P+N

630A S6-06303NS0
800A S6-08003ND0

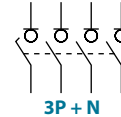
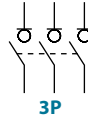

Technical information



tests:

According to IEC 60947-3

		630		800	
Rated thermal current in ambient at	I _{th} 40° C	A	630	800	
	50° C	A	630	800	
	60° C	A	630	800	
Rated insulation voltage	U _i	V	1000	1000	
Rated impulse withstand voltage	U _{imp}	kV	12	12	
AC Rated operational current ^{*(1)}	I _e Triphasic	U _e 400V AC23A	A	630	800
		U _e 690V AC21A	A	630	630
		U _e 800V AC21B	A	-	630 ^{*(3)}
Rated breaking capacity	400V, cos φ=0,35-0,45	A	5040	6400	
Rated making capacity	400V, cos φ=0,45	A	6300	8000	

		630		800	
Short - circuit behaviour					
Rated short-circuit making capacity ^{*(2)}	I _{cm} kA (peak)	26	26		
Rated short-time withstand current (1sec)	I _{cw} kA rms	16	16		
Mechanical features					
Number of mechanical operations (according to the standards, for other values please consult)	Cycles	5000	5000		
Maximum weight 2P	kg	3,91	3,91		
Maximum weight 3P	kg	4,76	4,76		
Maximum weight 3P+N	kg	5,70	5,70		

^{*(1)} Other voltages and / or utilization categories. Please consult
^{*(2)} Without limiting protective device (short-circuit maintained 50... 100 ms.)
^{*(3)} 3P/3P+N

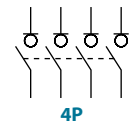

Also available 4P switch-disconnectors under request, please consult

Mounting positions

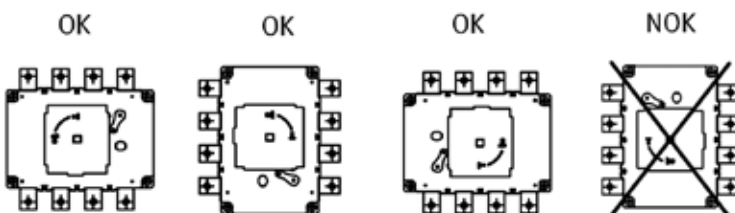

Warning: For the acceptable mounting positions, please consult the installation instructions. Do not install at 270 degrees orientation.



Accessories



» Direct handle

CODE DS-LI21



» External handle included shaft*(e1)

IP65
CODE DS-LA21



» External handle without shaft

IP65
CODE DS-LA24



» Emergency external handle included shaft*(e1)

IP65
CODE DS-LR21



» Terminal shrouds

CODE DR-CU21 (1 unit)
CODE DR-CU22 (1 unit)
CODE DR-CU23 (1 unit)



» Phase barriers

CODE DR-SF21 (1 unit)
CODE DR-SF22 (2 units)
CODE DR-SF23 (3 units)



» Spacers

CODE DR-EL21 (4 units)

» Shafts

Standard shaft included*(e1)

L (mm)	P (mm)
195	134... 240

Shaft extensions

Type 1

L (mm)	P (mm)	CODE
345	134... 400	DS-EP23

Type 2

L (mm)	P (mm)	CODE
535	134... 560	DS-EP24

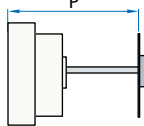
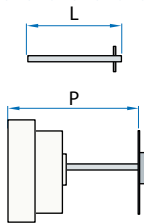

» Auxiliary contacts

1NO+1NC CODE D5LAU01
2NO+2NC CODE D5LAU02

Ie = 16 A (resistive loads)
4 A (inductive loads) at 250 Vac.

» Safety key lock device

Simple CODE DS-CB21
Double CODE DS-CF21

For external handle, lock the handle by means of a key in position "OFF" (under request, in "ON"), the key can only be removed with the handle locked

Door drilling for handle and key lock device

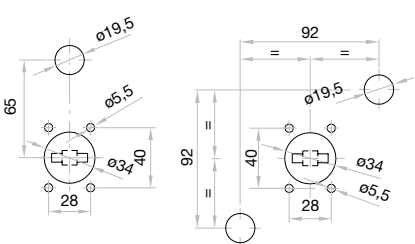

Dimensions (mm)

Door drilling for external handle

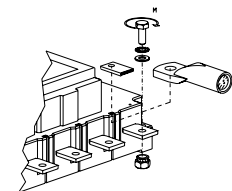
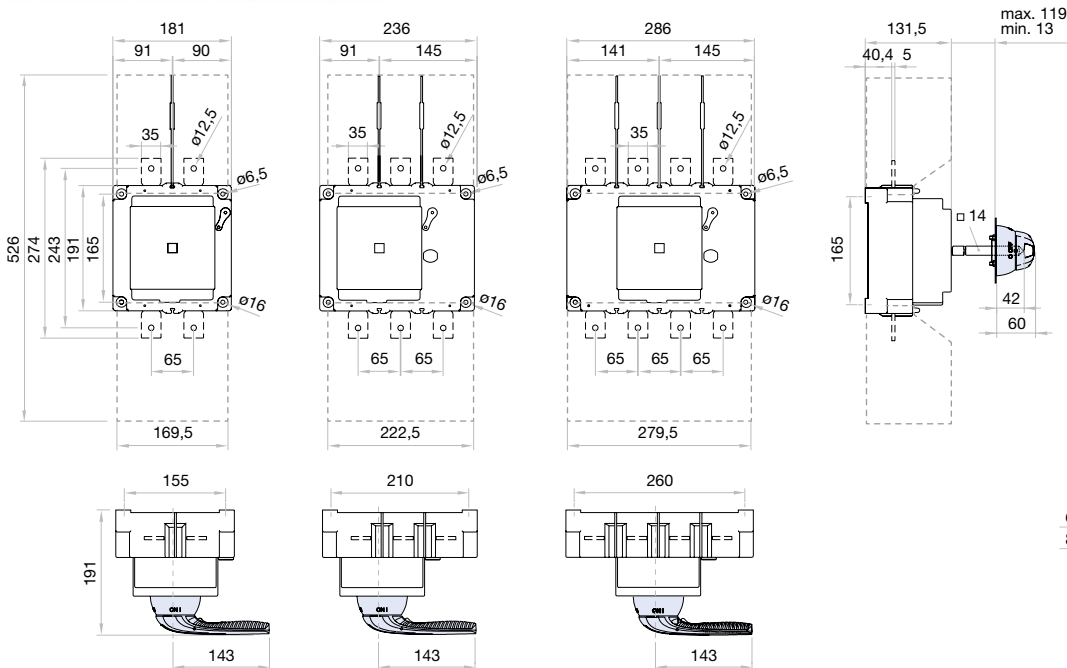
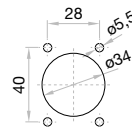

	S max (Cu) mm ²	H max (Cu) mm	L max (Cu) mm	M	M
630 A	2x185	2x6	35	M12	24
800 A	2x240	2x7	35	M12	24

Technical Sales Support

1300 876 722

estimating@tropac.com.au

WWW.TROPAC.COM.AU

Head Office

QLD: 19-27 Fred Chaplin Circuit, Bells Creek QLD 4551

Branch Locations

NSW: Unit 3/10 George Young St, Auburn NSW 2144

VIC: 193 O'Herns Rd, Epping VIC 3076

Version 1.0.0

© Copyright 2024 Tro Pacific Holdings Pty Ltd t/a TROPAC.
All rights reserved.