

Distributed by **TROPAC**

**telergon**  
gorlan



**CCF & CCP Series  
AC Changeover Switches**

# CCF | CCP Changeover switch base mounting 3P - 3P+N

Size 1

A 200|250|315|400

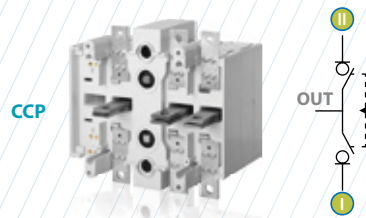
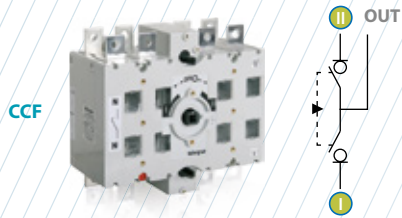

		CODE-200A	CODE-250A	CODE-315A	CODE-400A
CCF	3P	CCF02003PS0	CCF02503PS0	CCF03153PS0	CCF04003PS0
	3P + N	CCF02003NS0	CCF02503NS0	CCF03153NS0	CCF04003NS0
CCP	3P	CCP02003PS0	CCP02503PS0	CCP03153PS0	CCP04003PS0
	3P + N	CCP02003NS0	CCP02503NS0	CCP03153NS0	CCP04003NS0

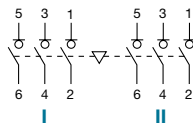

3P

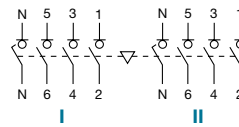

3P + N

## Technical information



consult

According to IEC 60947-3

			200	250	315	400
Rated thermal current	I <sub>th</sub> in ambient at 40° C	A	200	250	315	400
Rated insulation voltage	U <sub>i</sub>	V	1000	1000	1000	1000
Rated impulse withstand voltage	U <sub>imp</sub>	kV	8	8	8	8
AC Rated operational current <sup>*(1)</sup>	I <sub>e</sub> U <sub>e</sub> 400V AC21A	A	200	250	315	400
(Rated operational frequency 50/60 Hz)	U <sub>e</sub> 400V AC22A	A	200	250	315	400 <sup>*(3)</sup>

<sup>\*(1)</sup> Other voltages and / or utilization categories; please consult

<sup>\*(2)</sup> Without limiting protective device (short - circuit maintained 50 ms. - 100 ms.)

<sup>\*(3)</sup> AC22B

			200	250	315	400
Rated breaking capacity	400V AC22	A	600	750	945	1200
Rated making capacity	400V AC22	A	600	750	945	1200
<b>Short - circuit behaviour</b>						
Short - circuit making capacity <sup>*(2)</sup>	I <sub>cm</sub>	kA (peak)	12	12	12	12
Short - time withstand current (1 sec.)	I <sub>cw</sub>	kA rms	8	8	8	8
Number of mechanical operations (according to the standards, for other values please consult) <sup>*(3)</sup>	Cycles		8000	8000	8000	5000
Maximum weight (3/4 poles)	CCF	Kg	4,8/5,3	4,8/5,3	5/5,5	5/5,5
	CCP	Kg	5,3/5,9	5,3/5,9	5,5/6	5,5/6

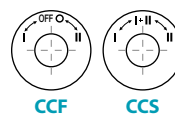

CCF

CCS

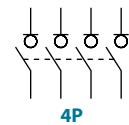

4P

There are versions of changeover switches without OFF 0 position: "overlapped contacts":

CCF (I - I+II - II) = CCS \_\_\_\_\_, please consult

Also available 4P changeover switches under request, please consult



Accessories



» Direct handle

CODE DCCL11



» External handle included shaft<sup>\*(e1)</sup>

IP65

CODE DCCLA11

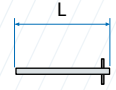

» Shafts

Standard shaft included<sup>\*(e1)</sup>

L (mm)	P (mm)
227	166... 293

Shaft extensions

Type 1

L (mm)	P (mm)	CODE
375	166... 442	DS-EP14

Type 2

L (mm)	P (mm)	CODE
536	166... 602	DS-EP15

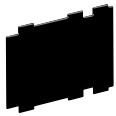

» Rear protective plate

3P	4P
DCCPP11	DCCPP12



» Terminal shrouds

POS. I	Inputs	POS. I&II	Common output	
3P	3P	3P+N	3P	3P+N
DM2CU12	DM2CU11	DM2CU13	DCCCU11	DCCCU12



» Auxiliary contacts

1NO+1NC	CODE	D5LAU01
2NO+2NC	CODE	D5LAU02

Ie = 16 A (resistive loads)  
4 A (inductive loads) at 250 Vac.



» Safety key lock device

Simple	CODE	D5LCB11
Double	CODE	D5LCF11

For external handle, lock the handle by means of a key in position "OFF" (under request, in "ON"), the key can only be removed with the handle locked

Door drilling for handle and key lock device

Simple

Double

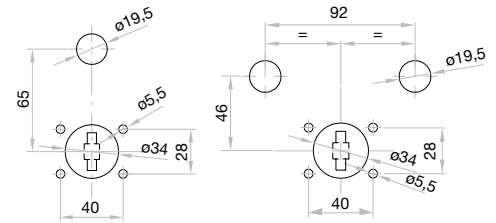

Dimensions (mm)

Door drilling for external handle

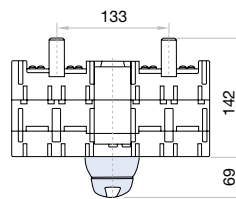
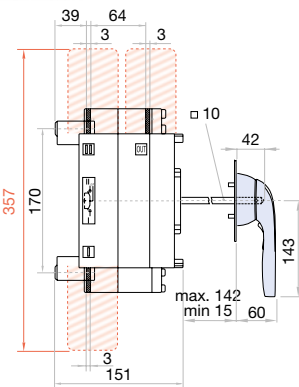
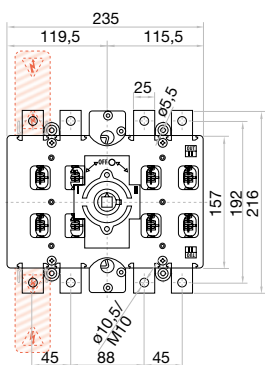
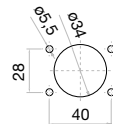

CCF

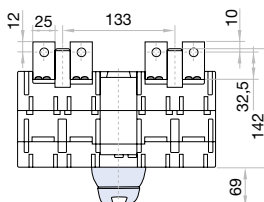
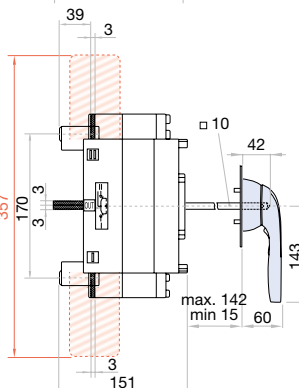

CCP

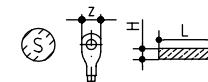
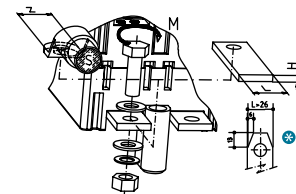

S max (Cu)	Z max	H max (Cu)	L max (Cu)	M
mm <sup>2</sup>	mm	mm	mm	Nxm
240	31	2x5	30*	M10 24

# CCF | CCP Changeover switch base mounting 3P - 3P+N

Size 2

A 500|630|800

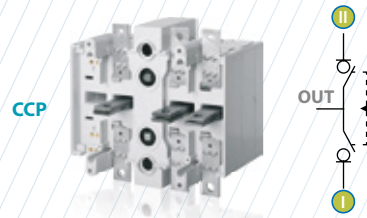
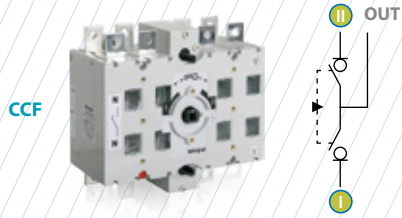

		CODE-500A	CODE-630A	CODE-800A
CCF	3P	CCF05003PS0	CCF06303PS0	CCF08003PS0
	3P + N	CCF05003NS0	CCF06303NS0	CCF08003NS0
CCP	3P	CCP05003PS0	CCP06303PS0	CCP08003PS0
	3P + N	CCP05003NS0	CCP06303NS0	CCP08003NS0

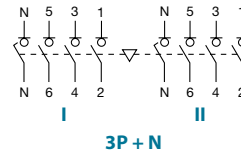
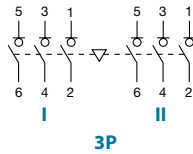

## Technical information



According to IEC 60947-3

			500	630	800
Rated thermal current	I <sub>th</sub> in ambient at 40° C	A	500	630	800
Rated insulation voltage	U <sub>i</sub>	V	1000	1000	1000
Rated impulse withstand voltage	U <sub>imp</sub>	kV	12	12	12
AC Rated operational current <sup>*(1)</sup>	I <sub>e</sub> U <sub>e</sub> 400V AC21A	A	500	630	800
(Rated operational frequency 50/60 Hz)	U <sub>e</sub> 400V AC22B	A	500	630	800

<sup>\*(1)</sup> Other voltages and / or utilization categories; please consult  
<sup>\*(2)</sup> Without limiting protective device (short - circuit maintained 50 ms. - 100 ms.)  
<sup>\*(3)</sup> AC22B

			500	630	800
Rated breaking capacity	400V AC22	A	1500	1890	2400
Rated making capacity	400V AC22	A	1500	1890	2400
<b>Short - circuit behaviour</b>					
Short - circuit making capacity <sup>*(2)</sup>	I <sub>cm</sub>	kA (peak)	20	20	20
Short - time withstand current (1 sec.)	I <sub>cw</sub>	kA rms	13	13	13
Number of mechanical operations (according to the standards, for other values please consult)	Cycles		5000	5000	3000
Maximum weight (3/4 poles)	CCF	Kg	11,5/12,6	11,5/12,6	11,9/13,2
	CCP	Kg	12,8/14,3	12,8/14,3	13/14,6

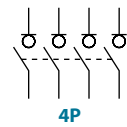
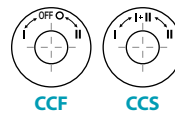

There are versions of changeover switches without OFF 0 position "overlapped contacts":

Also available 4P changeover switches under request, please consult

CCF (I - I+II - II) = CCS \_\_\_\_\_, please consult



Accessories



» Direct handle

CODE DCCL121



» External handle included shaft <sup>\*(e1)</sup>

IP65

CODE DCCLA21

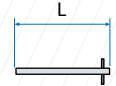

» Shafts

Standard shaft included <sup>\*(e1)</sup>

L (mm)	P (mm)	
195	195... 272	

Shaft extensions

Type 1

L (mm)	P (mm)	CODE
345	195... 422	DS-EP23

Type 2

L (mm)	P (mm)	CODE
535	195... 612	DS-EP24

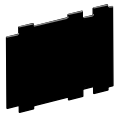

» Rear protective plate

3P	4P
DCCPP21	DCCPP22



» Terminal shrouds

POS. I	Inputs	POS. I&II	Common output	
3P	POS. II 3P	3P+N	3P	3P+N
DM2CU22	DM2CU21	DM2CU23	DCCCU21	DCCCU22



» Auxiliary contacts

1NO+1NC	CODE	D5LAU01
2NO+2NC	CODE	D5LAU02

I<sub>e</sub> = 16 A (resistive loads)  
4 A (inductive loads) at 250 Vac.



» Safety key lock device

Simple	CODE	D5LCB21
Double	CODE	D5LCF21

For external handle, lock the handle by means of a key in position "OFF" (under request, in "ON"), the key can only be removed with the handle locked

Door drilling for handle and key lock device

Simple

Double

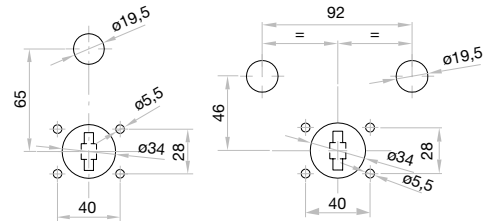

Dimensions (mm)

Door drilling for external handle

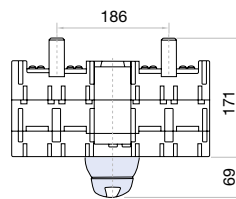
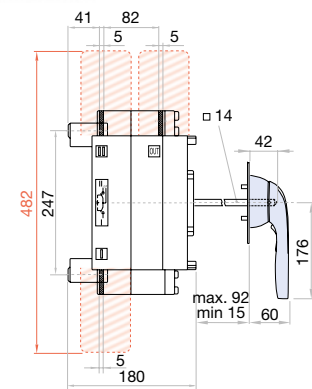
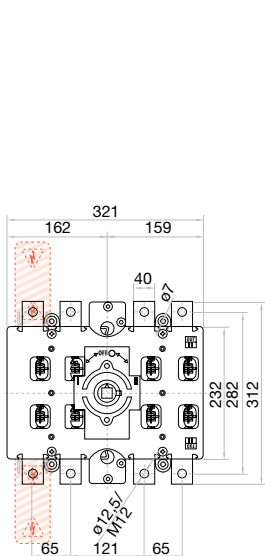
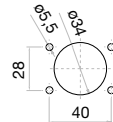

CCF

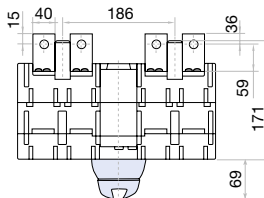
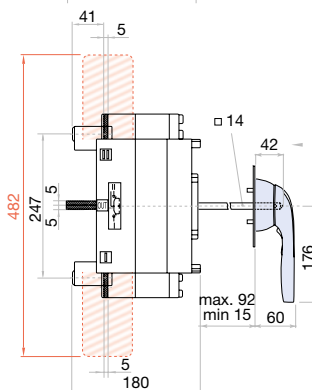

CCP

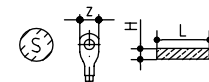
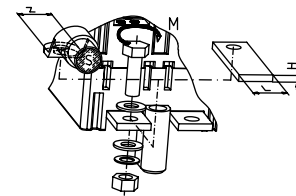

S max (Cu)	Z max	H max (Cu)	L max (Cu)	M
2x240	45	2x6	45	M12 45

# CCF | CCP Changeover switch base mounting 3P - 3P+N

Size 3

A 1000|1250

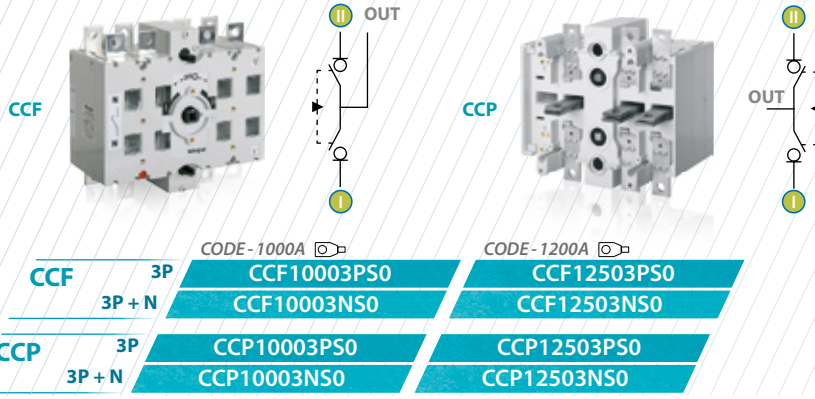

		CODE-1000A	CODE-1200A
CCF	3P	CCF10003PS0	CCF12503PS0
	3P + N	CCF10003NS0	CCF12503NS0
CCP	3P	CCP10003PS0	CCP12503PS0
	3P + N	CCP10003NS0	CCP12503NS0

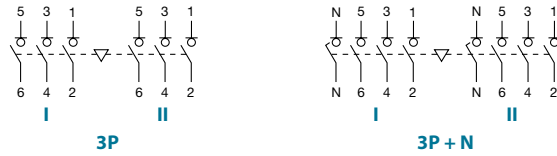

## Technical information



consult

According to IEC 60947-3

				1000	1250
Rated thermal current	I <sub>th</sub> in ambient at 40° C	A		1000	1250
Rated insulation voltage	U <sub>i</sub>	V		1000	1000
Rated impulse withstand voltage	U <sub>imp</sub>	kV		12	12
AC Rated operational current <sup>*(1)</sup>	I <sub>e</sub> U <sub>e</sub> 400V AC21A	A		1000	1250
(Rated operational frequency 50/60 Hz)	U <sub>e</sub> 400V AC22B	A		1000	1250

<sup>\*(1)</sup> Other voltages and / or utilization categories; please consult

<sup>\*(2)</sup> Without limiting protective device (short - circuit maintained 50 ms. - 100 ms.)

				1000	1250
Rated breaking capacity	400V AC22	A		3000	3750
Rated making capacity	400V AC22	A		3000	3750
<b>Short - circuit behaviour</b>					
Short - circuit making capacity <sup>*(2)</sup>	I <sub>cm</sub>	kA (peak)		32	32
Short - time withstand current (1 sec.)	I <sub>cw</sub>	kA rms		25	25
Number of mechanical operations (according to the standards, for other values please consult)		Cycles		3000	3000
Maximum weight (3/4 poles)	CCF	Kg		22,5 / 25	24,3 / 27,3
	CCP	Kg		25 / 28,3	26 / 29,7

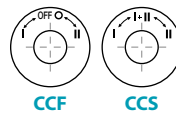

CCF CCS

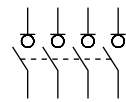

4P

There are versions of changeover switches without OFF 0 position: "overlapped contacts":  
CCF (I - I+II - II) = CCS....., please consult

Also available 4P changeover switches under request, please consult



Accessories



» Direct handle

CODE DCCLI31



» External handle included shaft <sup>\*(e1)</sup>

IP65  
CODE DCCLA31

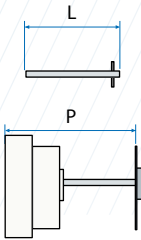

» Shafts

Standard shaft included <sup>\*(e1)</sup>

L (mm)	P (mm)
186	223... 298

Shaft extensions

Type 1		
L (mm)	P (mm)	CODE
345	223... 457	DS-EP23

Type 2		
L (mm)	P (mm)	CODE
535	223... 645	DS-EP24

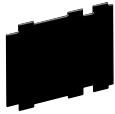

» Rear protective plate

3P	4P
DCCPP31	DCCPP32



» Terminal shrouds

Inputs		Common output	
POS. I 3P	POS. II 3P	POS. I&II 3P+N	3P 3P+N
DM2CU32	DM2CU31	DM2CU33	DCCCU31 DCCCU32



» Auxiliary contacts

1NO+1NC	CODE	D5LAU01
2NO+2NC	CODE	D5LAU02

I<sub>e</sub> = 16 A (resistive loads)  
4 A (inductive loads) at 250 Vac.



» Safety key lock device

Simple	CODE	D5LCB31
Double	CODE	D5LCF31

For external handle, lock the handle by means of a key in position "OFF" (under request, in "ON"), the key can only be removed with the handle locked

Door drilling for handle and key lock device

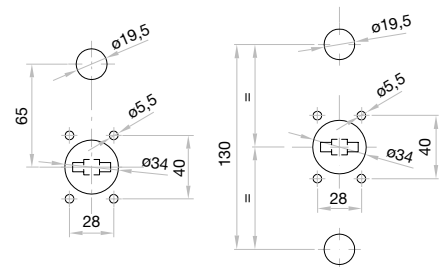

Dimensions (mm)

Door drilling for external handle

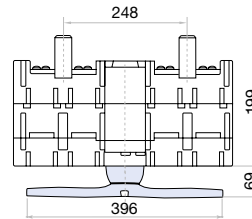
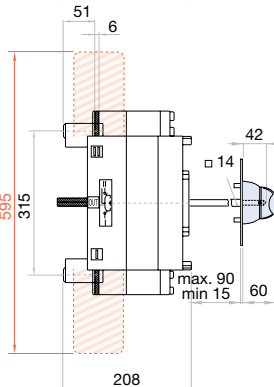
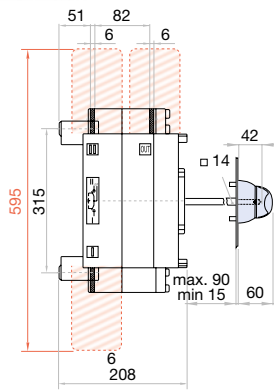
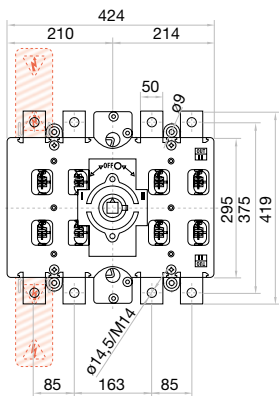
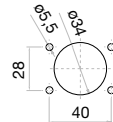

CCF

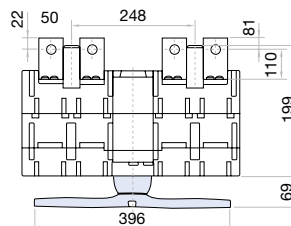

CCP

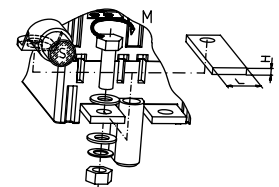

H max (Cu)	L max (Cu)	M
mm	mm	Nxm
2x10	60	M14 55

## Technical Sales Support

1300 876 722

[estimating@tropac.com.au](mailto:estimating@tropac.com.au)

[WWW.TROPAC.COM.AU](http://WWW.TROPAC.COM.AU)

### Head Office

QLD: 19-27 Fred Chaplin Circuit, Bells Creek QLD 4551

### Branch Locations

NSW: Unit 3/10 George Young St, Auburn NSW 2144

VIC: 193 O'Herns Rd, Epping VIC 3076

Version 1.0.0

© Copyright 2024 Tro Pacific Holdings Pty Ltd t/a TROPAC.

All rights reserved.